

Product data sheet

Specifications



Legend holder 40x50mm for flush mounted heads, Harmony XB5, plastic, without legend

ZBZF32

Main

Product Or Component Type	Legend holder
Accessory / Separate Part Category	Marking accessory

Complementary

Material	Plastic
Device Composition	Legend holder
Accessory / Separate Part Destination	Ø 22 mm control or signalling unit For built-in-flush head
Range Compatibility	Harmony XB4 Harmony XB5
Legend Holder Size	40 x 50 mm
Sale Per Indivisible Quantity	10
Net Weight	0.002 kg

Packing Units

Unit Type Of Package 1	PCE
Number Of Units In Package 1	1
Package 1 Height	2.0 cm
Package 1 Width	12.0 cm
Package 1 Length	17.0 cm
Package 1 Weight	2.0 g
Unit Type Of Package 2	BB1
Number Of Units In Package 2	10
Package 2 Height	2.0 cm
Package 2 Width	12.0 cm
Package 2 Length	17.0 cm
Package 2 Weight	21.0 g
Unit Type Of Package 3	S02
Number Of Units In Package 3	800
Package 3 Height	15.0 cm
Package 3 Width	30.0 cm
Package 3 Length	40.0 cm

Disclaimer: This documentation is not intended as a substitute for and is not to be used for determining suitability or reliability of these products for specific user applications

Package 3 Weight	2.495 kg
------------------	----------

Sustainability

Green Premium™ label is Schneider Electric's commitment to delivering products with best-in-class environmental performance. Green Premium promises compliance with the latest regulations, transparency on environmental impacts, as well as circular and low-CO₂ products.

Guide to assessing product sustainability is a white paper that clarifies global eco-label standards and how to interpret environmental declarations.

[Learn more about Green Premium >](#)

[Guide to assess a product's sustainability >](#)



Transparency RoHS/REACH

Well-being performance

✓ Reach Free Of Svhc

✓ Toxic Heavy Metal Free

✓ Mercury Free

✓ Rohs Exemption Information Yes

Certifications & Standards

Reach Regulation	REACH Declaration
Eu Rohs Directive	Pro-active compliance (Product out of EU RoHS legal scope) EU RoHS Declaration
China Rohs Regulation	China RoHS declaration
Environmental Disclosure	Product Environmental Profile
Circularity Profile	End of Life Information
California Proposition 65	WARNING: This product can expose you to chemicals including: Nickel compounds, which is known to the State of California to cause cancer, and Di-isodecyl phthalate (DIDP), which is known to the State of California to cause birth defects or other reproductive harm. For more information go to www.P65Warnings.ca.gov

Dimensions Drawings

Dimensions

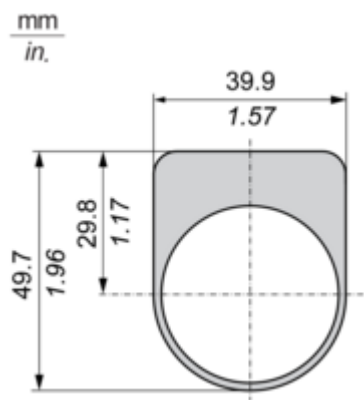

Mounting and Clearance

Panel Cut-out for Pushbuttons, Switches and Pilot Lights (Finished Holes, Ready for Installation)

For use on flat surface of a type 4, type 4X, type 12, and type 13

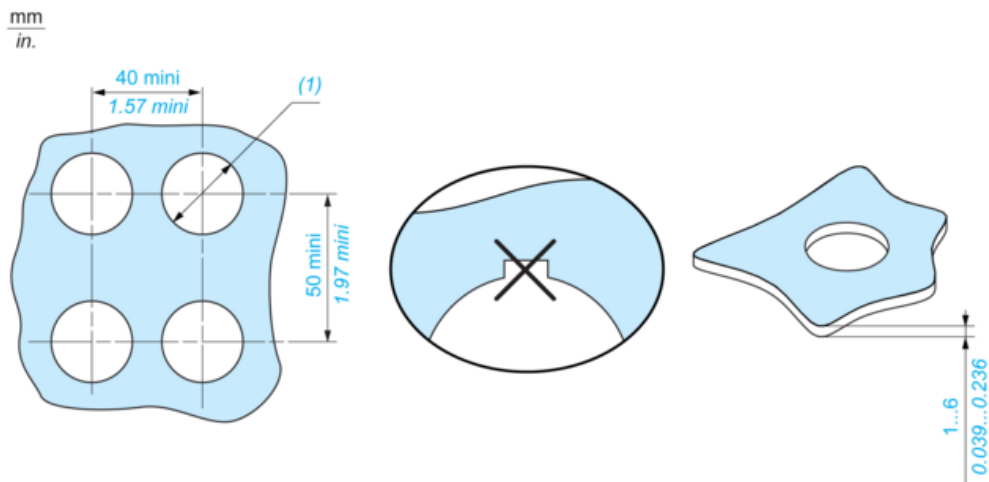

(1) Ø30.75 mm recommended (Ø30.5 mm $^{+0.5}_0$) / Ø1.21 in. recommended (Ø1.20 in. $^{+0.019}_0$)