

# Product data sheet

Specifications



## Head for key selector switch, Harmony XB5, flush mounted 455 2 pos stay put

ZB5FG02

### Main

|                               |                              |
|-------------------------------|------------------------------|
| Range Of Product              | Harmony XB5                  |
| Product Or Component Type     | Head for key selector switch |
| Device Short Name             | ZB5                          |
| Bezel Material                | Dark grey plastic            |
| Mounting Diameter             | 30.5 mm                      |
| Head Type                     | Built-in-flush               |
| Sale Per Indivisible Quantity | 1                            |
| Shape Of Signaling Unit Head  | Round                        |
| Type Of Operator              | stay put                     |
| Operator Profile              | Black key switch             |
| Operator Position Information | 2 positions 90°              |
| Type Of Keylock               | Key 455                      |
| Key Withdrawal Position       | Right                        |

### Complementary

|                             |  |
|-----------------------------|--|
| Cad Overall Width           | 37 mm  |
| Cad Overall Height          | 37 mm  |
| Cad Overall Depth           | 72 mm  |
| Net Weight                  | 0.069 kg   |
| Mechanical Durability       | 1000000 cycles   |
| Electrical Composition Code | C4 for <6 contacts using single and double blocks in front mounting<br>C5 for <5 contacts using single blocks in front mounting<br>C6 for <5 contacts using single and double blocks in front mounting<br>C7 for <4 contacts using single blocks in front mounting<br>C8 for <4 contacts using single and double blocks in front mounting<br>C11 for <3 contacts using single blocks in front mounting<br>C3 for <6 contacts using single blocks in front mounting<br>SF1 for <3 contacts using single blocks in front mounting<br>C15 for <1 contacts using single blocks in front mounting |

### Environment

|                                       |                                  |
|---------------------------------------|----------------------------------|
| Protective Treatment                  | TH                               |
| Ambient Air Temperature For Storage   | -40...70 °C                      |
| Ambient Air Temperature For Operation | -40...70 °C                      |
| Overvoltage Category                  | Class II conforming to IEC 60536 |

Disclaimer: This documentation is not intended as a substitute for and is not to be used for determining suitability or reliability of these products for specific user applications

|                                    |  |
|------------------------------------|--|
| Ip Degree Of Protection            | IP66 conforming to IEC 60529<br>IP67<br>IP69<br>IP69K  |
| Nema Degree Of Protection          | NEMA 13<br>NEMA 4X   |
| Resistance To High Pressure Washer | 7000000 Pa at 55 °C, distance : 0.1 m  |
| Ik Degree Of Protection            | IK03 conforming to IEC 50102   |
| Standards                          | EN/IEC 60947-1<br>JIS C8201-5-1<br>UL 508<br>EN/IEC 60947-5-1<br>EN/IEC 60947-5-4<br>CSA C22.2 No 14<br>JIS C8201-1  |
| Product Certifications             | BV<br>UL listed<br>DNV<br>LROS (Lloyds register of shipping)<br>GL<br>CSA  |
| Vibration Resistance               | 5 gn (f= 2...500 Hz) conforming to IEC 60068-2-6   |
| Shock Resistance                   | 30 gn (duration = 18 ms) for half sine wave acceleration conforming to IEC 60068-2-27<br>50 gn (duration = 11 ms) for half sine wave acceleration conforming to IEC 60068-2-27 |

## Packing Units

|                              |         |
|------------------------------|---------|
| Unit Type Of Package 1       | PCE     |
| Number Of Units In Package 1 | 1       |
| Package 1 Height             | 8.89 cm |
| Package 1 Width              | 4.57 cm |
| Package 1 Length             | 5.33 cm |
| Package 1 Weight             | 0.07 kg |

## Sustainability

**Green Premium™ label** is Schneider Electric's commitment to delivering products with best-in-class environmental performance. Green Premium promises compliance with the latest regulations, transparency on environmental impacts, as well as circular and low-CO<sub>2</sub> products.

**Guide to assessing product sustainability** is a white paper that clarifies global eco-label standards and how to interpret environmental declarations.

[Learn more about Green Premium >](#)

[Guide to assess a product's sustainability >](#)



Transparency   RoHS/REACH

## Well-being performance

✓ Mercury Free

✓ Rohs Exemption Information   [Yes](#)

## Certifications & Standards

|                           |   |
|---------------------------|---|
| Reach Regulation          | <a href="#">REACH Declaration</a>   |
| Eu Rohs Directive         | Pro-active compliance (Product out of EU RoHS legal scope)  |
| China Rohs Regulation     | <a href="#">China RoHS declaration</a>  |
| Environmental Disclosure  | <a href="#">Product Environmental Profile</a>   |
| Circularity Profile       | <a href="#">End of Life Information</a>   |
| California Proposition 65 | WARNING: This product can expose you to chemicals including: Lead and lead compounds, which is known to the State of California to cause cancer and birth defects or other reproductive harm. For more information go to <a href="http://www.P65Warnings.ca.gov">www.P65Warnings.ca.gov</a> |

Dimensions Drawings

Dimensions

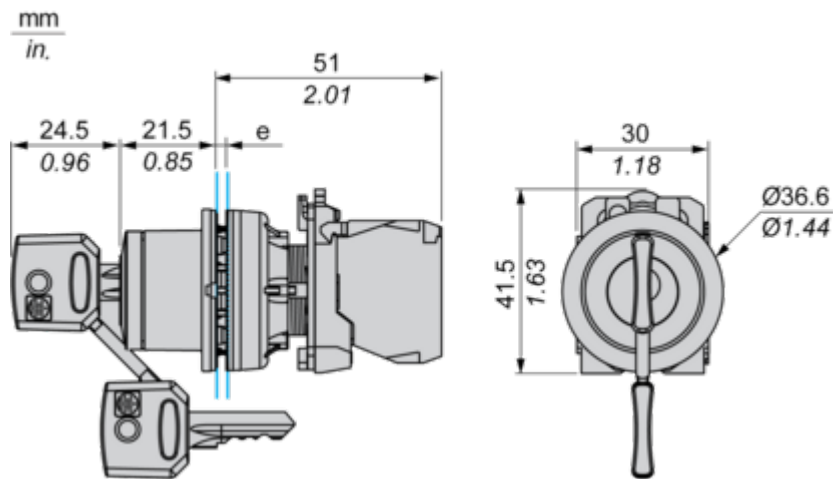

e: Clamping thickness: 1 to 6 mm / 0.04 to 0.24 in.

Mounting and Clearance

Panel Cut-out for Pushbuttons, Switches and Pilot Lights (Finished Holes, Ready for Installation)

Connection by Screw Clamp Terminals or Plug-in Connectors



- (1) Diameter on finished panel or support  
(2) Ø30.75 mm recommended ( $\text{Ø}30.5 \begin{smallmatrix} +0.5 \\ 0 \end{smallmatrix}$ ) / Ø1.21 in. recommended ( $\text{Ø}1.20 \text{ in. } \begin{smallmatrix} +0.0196 \\ 0 \end{smallmatrix}$ )

| Connections                                   | a in mm | a in in. | b in mm | b in in. |
|---|---------|----------|---------|----------|
| By screw clamp terminals or plug-in connector | 40      | 1.57     | 40      | 1.57     |
| By Faston connectors                          | 45      | 1.77     | 40      | 1.57     |

Technical Description

Electrical Composition Corresponding to Code C3

---

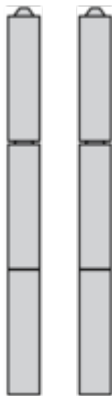

Electrical Composition Corresponding to Code C4

---



Electrical Composition Corresponding to Code C5

---

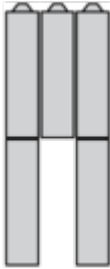



Electrical Composition Corresponding to Code C6

---



Electrical Composition Corresponding to Code C7

---

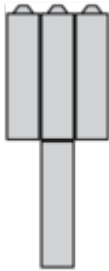

Electrical Composition Corresponding to Code C8

---



Electrical Composition Corresponding to Codes C9, C11, SF1 and SR1



Electrical Composition Corresponding to Code C15

1 N/O



1 N/C

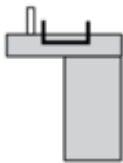

1 N/O + N/C or 1 N/O + N/O or 1 N/C + N/C



Legend

---

Single contact



Double contact



Light block



Possible location



Sequence of Contacts Fitted to 2-position Selector Switch Body

Position 315°



|          |          |        |        |        |        |
|----------|----------|--------|--------|--------|--------|
| Push     | Position | Top    |        |        |        |
|          |          | Bottom |        |        |        |
|          | Location |        | Left   | Centre | Right  |
|          | State    |        | 0      | 0      | 0      |
|          |          |        |        |        |        |
| Contacts | N/O      |        | open   | open   | open   |
|          | N/C      |        | closed | closed | closed |

Position 45°



|          |          |        |        |        |        |
|----------|----------|--------|--------|--------|--------|
| Push     | Position | Top    |        |        |        |
|          |          | Bottom |        |        |        |
|          | Location |        | Left   | Centre | Right  |
|          | State    |        | 1      | 1      | 1      |
|          |          |        |        |        |        |
| Contacts | N/O      |        | closed | closed | closed |
|          | N/C      |        | open   | open   | open   |