

Product data sheet

Specifications



Base station, Harmony eXLhoist, compact, Receiver, 10 relays outputs, cable gland connection, 48...240V AC

ZARB10WS

Main

Range Of Product	Harmony eXLhoist
Product Or Component Type	Base station
Device Short Name	ZARB
Product Specific Application	Material handling Hoisting applications

Complementary

Cable Entry	Cable gland
Material	ABS + PC
[Us] Rated Supply Voltage	48...240 V AC
Provided Equipment	Internal antenna
Nominal Output Current	0.5 A at 48 V AC conforming to IEC 60947-5-1
Number Of Relays	10
Relay Type	Motion relay outputs with 9 NO contact Auxiliary relay outputs with 1 NO contact
Safety Outputs	2 NC relay outputs
Maximum Switching Current	10 A
Maximum Switching Voltage	240 V AC (+/- 20 %)
Communication Network Type	Wireless: Zigbee
Transmission Frequency	2.4 GHz
Maximum Sensing Distance	100 m in free field
Fixing Mode	4 holes
Electrical Durability	100000 cycles
Mechanical Durability	10000000 cycles
Width	120 mm
Height	117 mm
Depth	51 mm
Net Weight	0.43 kg

Environment

Ip Degree Of Protection	IP66
Radio Agreement	FCC IC

Disclaimer: This documentation is not intended as a substitute for and is not to be used for determining suitability or reliability of these products for specific user applications

Relative Humidity	0...97 %
Ambient Air Temperature For Operation	-20...55 °C
Ambient Air Temperature For Storage	-40...70 °C
Product Certifications	CE

Packing Units

Unit Type Of Package 1	PCE
Number Of Units In Package 1	1
Package 1 Height	6.8 cm
Package 1 Width	17.2 cm
Package 1 Length	14.4 cm
Package 1 Weight	534.0 g
Unit Type Of Package 2	S03
Number Of Units In Package 2	9
Package 2 Height	30.0 cm
Package 2 Width	30.0 cm
Package 2 Length	40.0 cm
Package 2 Weight	5.129 kg

Sustainability



Green Premium™ label is Schneider Electric’s commitment to delivering products with best-in-class environmental performance. Green Premium promises compliance with the latest regulations, transparency on environmental impacts, as well as circular and low-CO₂ products.

Guide to assessing product sustainability is a white paper that clarifies global eco-label standards and how to interpret environmental declarations.

[Learn more about Green Premium >](#)

[Guide to assess a product’s sustainability >](#)

Well-being performance

 Mercury Free	
 Rohs Exemption Information	Yes
Eu Rohs Directive	Pro-active compliance (Product out of EU RoHS legal scope)
China Rohs Regulation	China RoHS declaration
Weee	The product must be disposed on European Union markets following specific waste collection and never end up in rubbish bins
California Proposition 65	WARNING: This product can expose you to chemicals including: Nickel compounds, which is known to the State of California to cause cancer, and Di-isodecyl phthalate (DIDP), which is known to the State of California to cause birth defects or other reproductive harm. For more information go to www.P65Warnings.ca.gov

Dimensions Drawings

Dimensions

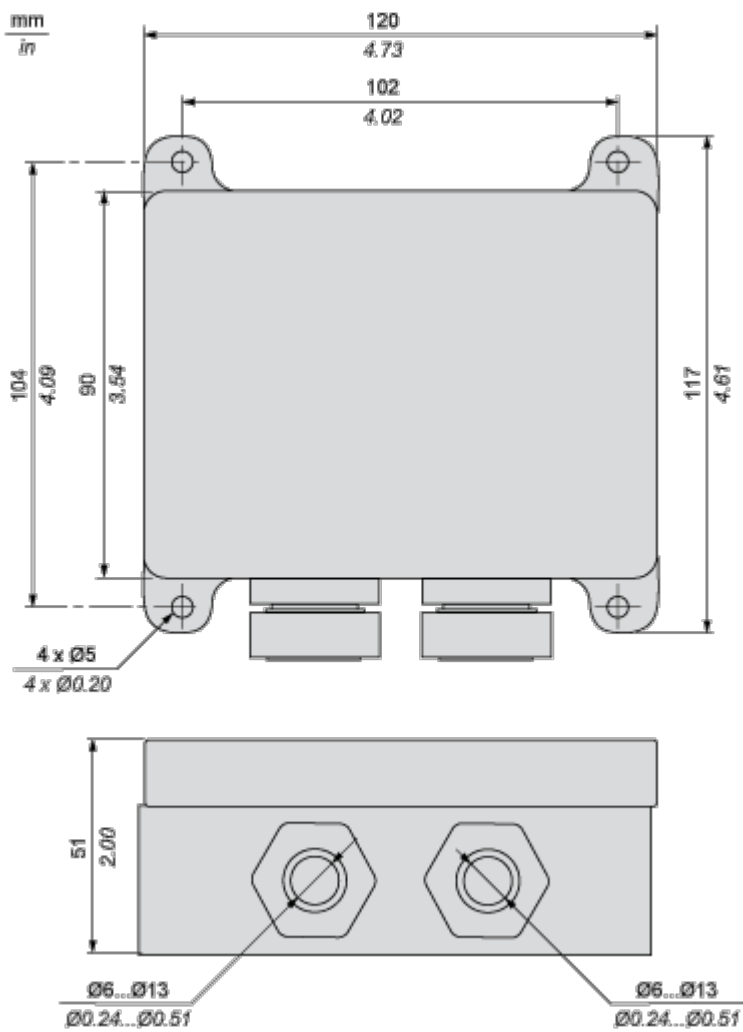

Connections and Schema

Wiring Diagram

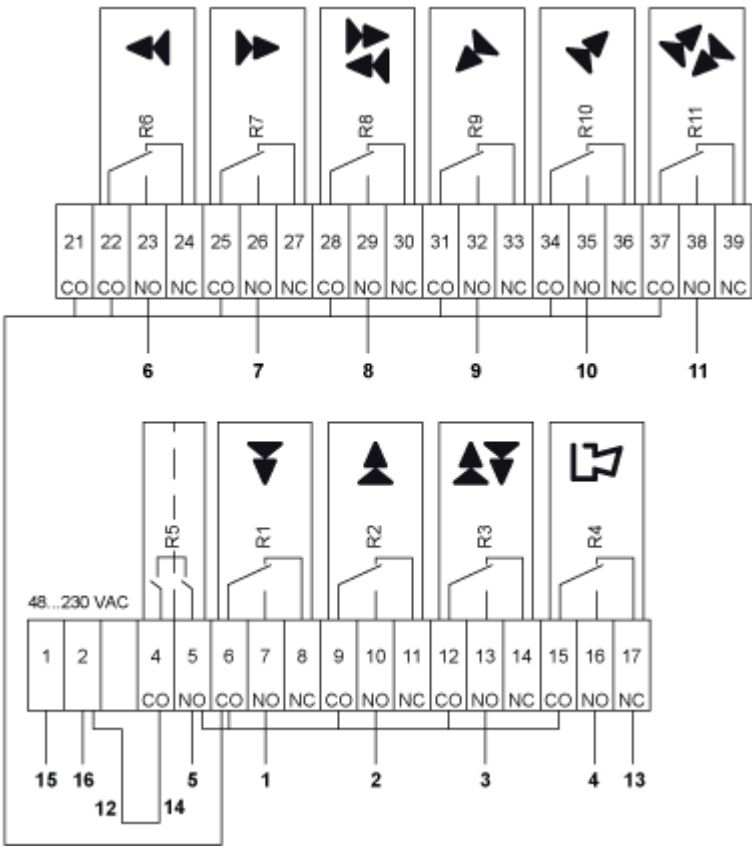

Signal		Pin number
Power supply		1
Power supply		2
Not connected		3
Stop relay R5	Common	4
	Output (NO type)	5
Relay R1	Common	6
	Output (NO type)	7
	Output (NC type)	8
Relay R2	Common	9
	Output (NO type)	10
	Output (NC type)	11
Relay R3	Common	12

Signal		Pin number
	Output (NO type)	13
	Output (NC type)	14
Relay R4	Common	15
	Output (NO type)	16
	Output (NC type)	17
Common		21
Relay R6	Common	22
	Output (NO type)	23
	Output (NC type)	24
Relay R7	Common	25
	Output (NO type)	26
	Output (NC type)	27
Relay R8	Common	28
	Output (NO type)	29
	Output (NC type)	30
Relay R9	Common	31
	Output (NO type)	32
	Output (NC type)	33
Relay R10	Common	34
	Output (NO type)	35
	Output (NC type)	36
Relay R11	Common	37
	Output (NO type)	38
	Output (NC type)	39