

Product data sheet

Specifications



Pre assembled and pre cabled indicator bank, Harmony XVM, beacon, without buzzer + 2 illuminated units, Ø 45 mm, 230 V AC

XVMM2RGHSB

⚠ Discontinued

⚠ Discontinued on: Oct 20, 2020

Main

| | |
|------------------------------------|--|
| Range Of Product | Harmony XVM |
| Product Or Component Type | Pre-assembled and pre-cabled indicator bank |
| Beacon Or Indicator Bank Unit Type | 2 illuminated units |
| Component Name | XVM |
| Light Source | Green super bright LED with BA 15d base steady signalling Red super bright LED with BA 15d base steady signalling |
| Light Block Color | Red/green |
| [Us] Rated Supply Voltage | 230 V AC |
| Indicator Bank Base Type | Base without buzzer |
| Mounting Mode | Horizontal |

Complementary

| | |
|--|--|
| Kit Composition | Aluminium support tube Base unit Cover Plastic fixing plate |
| Mounting Diameter | 45 mm |
| Connections - Terminals | Flying leads,clamping capacity: 1 x 0.325 mm² (AWG 22) |
| Marking | CE |
| Mounting Support | Aluminium tube |
| Short-Circuit Protection | 0.2 A |
| [Ui] Rated Insulation Voltage | 250 V conforming to IEC 60947-1 |
| Nominal Voltage Limit | 0.85...1.1 Un conforming to IEC 60947-5-1 |
| Current Consumption | 15 mA on steady LED unit |
| [Uimp] Rated Impulse Withstand Voltage | 4 kV conforming to IEC 60947-1 |

Environment

| | |
|-------------------------|--|
| Ip Degree Of Protection | IP54 horizontal position conforming to IEC 60529 |
| Product Certifications | CCC |
| Standards | EN/IEC 60947-5-1 EN/IEC 60947-1 |

Disclaimer: This documentation is not intended as a substitute for and is not to be used for determining suitability or reliability of these products for specific user applications

| | |
|---------------------------------------|---|
| Ambient Air Temperature For Storage | -25...70 °C |
| Ambient Air Temperature For Operation | -10...50 °C |
| Overvoltage Category | Class I conforming to IEC 60947-1 Class I conforming to IEC 60947-5-1 Class I conforming to IEC 61140 |
| Protective Treatment | TC |

Packing Units

| | |
|------------------------------|---------|
| Unit Type Of Package 1 | PCE |
| Number Of Units In Package 1 | 1 |
| Package 1 Height | 7.8 cm |
| Package 1 Width | 8.5 cm |
| Package 1 Length | 50.4 cm |
| Package 1 Weight | 425 g |

Contractual warranty

| | |
|----------|-----------|
| Warranty | 18 months |
|----------|-----------|

Dimensions Drawings

Pre-Assembled and Pre-Cabled Tower Light with Fixing Base for Mounting on Horizontal Support (Support Tube + Plastic Fixing Plate)

Dimensions

Below drawing shows a tower light with 3 illuminated stages. Select the number of stages according to the product characteristics in order to get **b1** dimension.

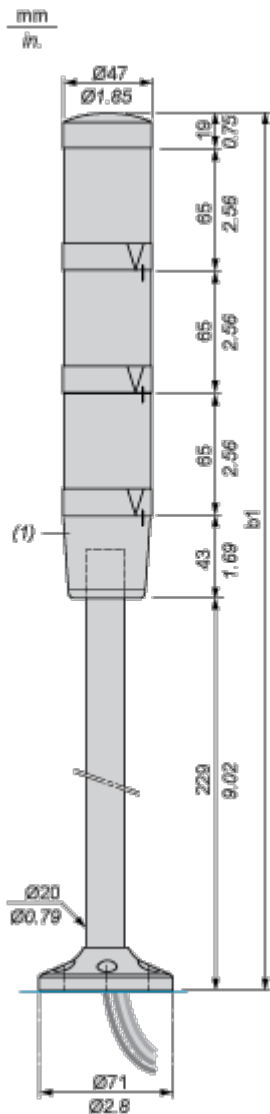

(1) Base unit with or without buzzer.

| Number of illuminated units | b1 in mm | b1 in in. |
|-----------------------------|----------|-----------|
| 1 unit | 356 | 14.02 |
| 2 units | 421 | 16.57 |
| 3 units | 486 | 19.13 |
| 4 units | 551 | 21.69 |

Connections and Schema

Pre-Assembled and Pre-Cabled Tower Light

Wire Colors

- 4th illuminated unit: yellow wire
- 3rd illuminated unit: green wire
- 2nd illuminated unit: white wire
- 1st illuminated unit: blue wire
- Common: black wire
- Buzzer (if integrated in base unit): grey wire