

# Product data sheet

Specifications



## indicator bank with buzzer + 3 illuminated units - Ø 45 mm - 120 V AC

XVMG2RAGSHSB

 **Discontinued on:** Jan 29, 2021

 **Discontinued**

### Main

Range Of Product	Harmony XVM
Product Or Component Type	Pre-assembled and pre-cabled indicator bank
Beacon Or Indicator Bank Unit Type	3 illuminated units
Component Name	XVM
Light Source	Green super bright LED with BA 15d base steady signalling Orange super bright LED with BA 15d base steady signalling Red super bright LED with BA 15d base steady signalling
Light Block Color	Red/orange/green
[Us] Rated Supply Voltage	120 V AC
Indicator Bank Base Type	Base with integrated buzzer
Mounting Mode	Horizontal

### Complementary

Kit Composition	Cover Plastic fixing plate Aluminium support tube Base unit
Mounting Diameter	45 mm
Connections - Terminals	Flying leads,clamping capacity: 1 x 0.325 mm <sup>2</sup> (AWG 22)
Marking	CE
Mounting Support	Aluminium tube
Short-Circuit Protection	0.2 A
[Ui] Rated Insulation Voltage	250 V conforming to IEC 60947-1
Nominal Voltage Limit	0.85...1.1 Un conforming to IEC 60947-5-1
Current Consumption	18 mA on base unit 16 mA on steady LED unit
[Uimp] Rated Impulse Withstand Voltage	4 kV conforming to IEC 60947-1
Fundamental Frequency	4 kHz

### Environment

Ip Degree Of Protection	IP54 horizontal position conforming to IEC 60529
Product Certifications	CCC
Standards	EN/IEC 60947-1 EN/IEC 60947-5-1

Disclaimer: This documentation is not intended as a substitute for and is not to be used for determining suitability or reliability of these products for specific user applications

Ambient Air Temperature For Storage	-25...70 °C
Ambient Air Temperature For Operation	-10...50 °C
Overvoltage Category	Class I conforming to IEC 60947-1 Class I conforming to IEC 60947-5-1 Class I conforming to IEC 61140
Protective Treatment	TC
Noise Level	0...80 dB at 1 m

## Contractual warranty

Warranty	18 months
----------	-----------

# Sustainability

**Green Premium™** label is Schneider Electric's commitment to delivering products with best-in-class environmental performance. Green Premium promises compliance with the latest regulations, transparency on environmental impacts, as well as circular and low-CO<sub>2</sub> products.

**Guide to assessing product sustainability** is a white paper that clarifies global eco-label standards and how to interpret environmental declarations.

[Learn more about Green Premium >](#)

[Guide to assess a product's sustainability >](#)



Transparency   RoHS/REACH

## Well-being performance

✓ Mercury Free

✓ Rohs Exemption Information   [Yes](#)

## Certifications & Standards

Reach Regulation	<a href="#">REACH Declaration</a>
Eu Rohs Directive	Pro-active compliance (Product out of EU RoHS legal scope)
China Rohs Regulation	<a href="#">China RoHS declaration</a>
Environmental Disclosure	<a href="#">Product Environmental Profile</a>
Weee	The product must be disposed on European Union markets following specific waste collection and never end up in rubbish bins
Circularity Profile	No need of specific recycling operations
California Proposition 65	WARNING: This product can expose you to chemicals including: Lead and lead compounds, which is known to the State of California to cause cancer and birth defects or other reproductive harm. For more information go to <a href="http://www.P65Warnings.ca.gov">www.P65Warnings.ca.gov</a>

Dimensions Drawings

Pre-Assembled and Pre-Cabled Tower Light with Fixing Base for Mounting on Horizontal Support (Support Tube + Plastic Fixing Plate)

Dimensions

Below drawing shows a tower light with 3 illuminated stages. Select the number of stages according to the product characteristics in order to get **b1** dimension.

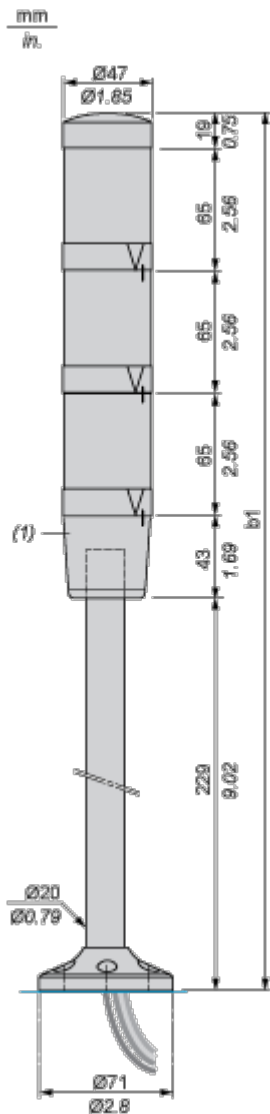

(1) Base unit with or without buzzer.

Number of illuminated units	b1 in mm	b1 in in.
1 unit	356	14.02
2 units	421	16.57
3 units	486	19.13
4 units	551	21.69

Connections and Schema

Pre-Assembled and Pre-Cabled Tower Light

---

Wire Colors

- 4th illuminated unit: yellow wire
- 3rd illuminated unit: green wire
- 2nd illuminated unit: white wire
- 1st illuminated unit: blue wire
- Common: black wire
- Buzzer (if integrated in base unit): grey wire

Technical Description

Base Unit with Integral Buzzer

---

Adjustment of Audible Signal

View from above:

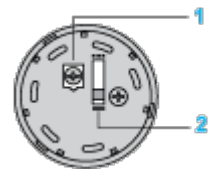

- (1) Volume adjustment potentiometer: 0 to 85 dB. Use either a cross headed or flat tipped screwdriver.
- (2) 2-position selector for type of audible signal: continuous tone or intermittent tone