

Product data sheet

Specifications



Inductive proximity sensors XS,
accessory for sensor, Ø 8 mm, fixing
clamp with indexing, plastic

XSZB108

Main

Range Of Product	Telemecanique Inductive proximity sensors XS
Accessory / Separate Part Category	Mounting and fixing accessories
Accessory / Separate Part Type	Fixing clamp
Accessory / Separate Part Designation	Fixing clamp
Accessory / Separate Part Destination	Cylindrical M8 sensor
Material	Plastic

Complementary

Product Compatibility	XU cylindrical M8 XS cylindrical M8
Net Weight	0.006 kg

Packing Units

Unit Type Of Package 1	PCE
Number Of Units In Package 1	1
Package 1 Height	2.5 cm
Package 1 Width	3.0 cm
Package 1 Length	5.0 cm
Package 1 Weight	9.0 g
Unit Type Of Package 2	S01
Number Of Units In Package 2	100
Package 2 Height	15.0 cm
Package 2 Width	15.0 cm
Package 2 Length	40.0 cm
Package 2 Weight	1.109 kg

Contractual warranty

Warranty	18 months
----------	-----------

Disclaimer: This documentation is not intended as a substitute for and is not to be used for determining suitability or reliability of these products for specific user applications

Sustainability

Green Premium™ label is Schneider Electric's commitment to delivering products with best-in-class environmental performance. Green Premium promises compliance with the latest regulations, transparency on environmental impacts, as well as circular and low-CO₂ products.

Guide to assessing product sustainability is a white paper that clarifies global eco-label standards and how to interpret environmental declarations.

[Learn more about Green Premium >](#)

[Guide to assess a product's sustainability >](#)



RoHS/REACH

Well-being performance

✓ Mercury Free

✓ Rohs Exemption Information [Yes](#)

Certifications & Standards

Reach Regulation [REACH Declaration](#)

Eu Rohs Directive Pro-active compliance (Product out of EU RoHS legal scope)

Circularity Profile [End of Life Information](#)

California Proposition 65
WARNING: This product can expose you to chemicals including: Diisononyl phthalate (DINP), which is known to the State of California to cause cancer, and Diisodecyl phthalate (DIDP), which is known to the State of California to cause birth defects or other reproductive harm. For more information go to www.P65Warnings.ca.gov

Dimensions Drawings

Dimensions

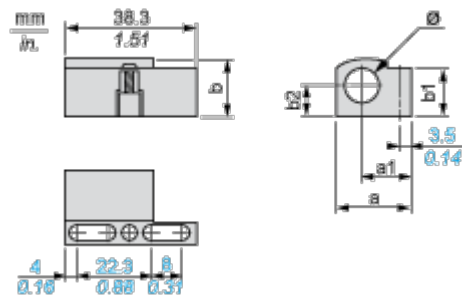

Dimensions in mm

a	a1	b	b1	b2	Ø
19.9	14.5	14	12.5	7.5	8

Dimensions in in.

a	a1	b	b1	b2	Ø
0.78	0.57	0.55	0.49	0.30	0.31