

Product data sheet

Specifications



Inductive proximity sensors XS,
inductive sensor XS8 80x80x26,
PBT, Sn60mm, 24...240VAC/DC,
cable 2 m

XS8D1A1MAL2

Main

Range Of Product	Telemecanique Inductive proximity sensors XS
Series Name	General purpose
Sensor Type	Inductive proximity sensor
Device Application	-
Sensor Name	XS8
Sensor Design	Flat form 80 x 80 x 26
Size	26 mm
Body Type	Fixed
Detector Flush Mounting Acceptance	Non flush mountable
Material	Plastic
Enclosure Material	PBT
Type Of Output Signal	Discrete
Wiring Technique	2-wire
[Sn] Nominal Sensing Distance	40 mm flush mountable 60 mm non flush mountable
Discrete Output Function	1 NO
Output Circuit Type	AC/DC
Electrical Connection	Cable
Cable Length	2 m
[Us] Rated Supply Voltage	24...240 V AC/DC 50/60 Hz
Switching Capacity In Ma	5...200 mA DC 5...300 mA AC
Ip Degree Of Protection	IP68 double insulation conforming to IEC 60529

Complementary

Detection Face	Frontal
Front Material	PBT
Fine Adjustment Zone	20...40 mm flush mountable 20...60 mm non flush mountable
Differential Travel	1...15% of Sr
Cable Composition	2 x 0.34 mm²
Wire Insulation Material	PVC

Disclaimer: This documentation is not intended as a substitute for and is not to be used for determining suitability or reliability of these products for specific user applications

Supply Voltage Limits	20...264 V AC/DC
Maximum Residual Current	1.5 mA open state
Switching Frequency	<= 150 Hz
Maximum Voltage Drop	<5.5 V (closed)
Current Consumption	<= 10 mA no-load
Maximum Delay First Up	15 ms
Maximum Delay Response	0.3 ms
Maximum Delay Recovery	6 ms
Marking	CE
Depth	26 mm
Height	80 mm
Width	80 mm

Environment

Product Certifications	Ecolab CSA UL CCC
Ambient Air Temperature For Operation	-25...70 °C
Ambient Air Temperature For Storage	-40...85 °C
Vibration Resistance	25 gn amplitude = +/- 2 mm (f = 10...55 Hz) conforming to IEC 60068-2-6
Shock Resistance	50 gn for 11 ms conforming to IEC 60068-2-27

Packing Units

Unit Type Of Package 1	PCE
Number Of Units In Package 1	1
Package 1 Height	13.000 cm
Package 1 Width	9.500 cm
Package 1 Length	6.600 cm
Package 1 Weight	428.000 g
Unit Type Of Package 2	S02
Number Of Units In Package 2	14
Package 2 Height	15 cm
Package 2 Width	30 cm
Package 2 Length	40 cm
Package 2 Weight	6.307 kg

Contractual warranty

Warranty	18 months
----------	-----------

Sustainability

Green Premium™ label is Schneider Electric's commitment to delivering products with best-in-class environmental performance. Green Premium promises compliance with the latest regulations, transparency on environmental impacts, as well as circular and low-CO₂ products.

Guide to assessing product sustainability is a white paper that clarifies global eco-label standards and how to interpret environmental declarations.

[Learn more about Green Premium >](#)

[Guide to assess a product's sustainability >](#)



RoHS/REACH

Well-being performance

✓ Mercury Free

✓ Rohs Exemption Information [Yes](#)

Certifications & Standards

Reach Regulation	REACH Declaration
Eu Rohs Directive	Pro-active compliance (Product out of EU RoHS legal scope)
Circularity Profile	No need of specific recycling operations
California Proposition 65	WARNING: This product can expose you to chemicals including: Diisononyl phthalate (DINP), which is known to the State of California to cause cancer, and Diisodecyl phthalate (DIDP), which is known to the State of California to cause birth defects or other reproductive harm. For more information go to www.P65Warnings.ca.gov

Dimensions Drawings

Dimensions

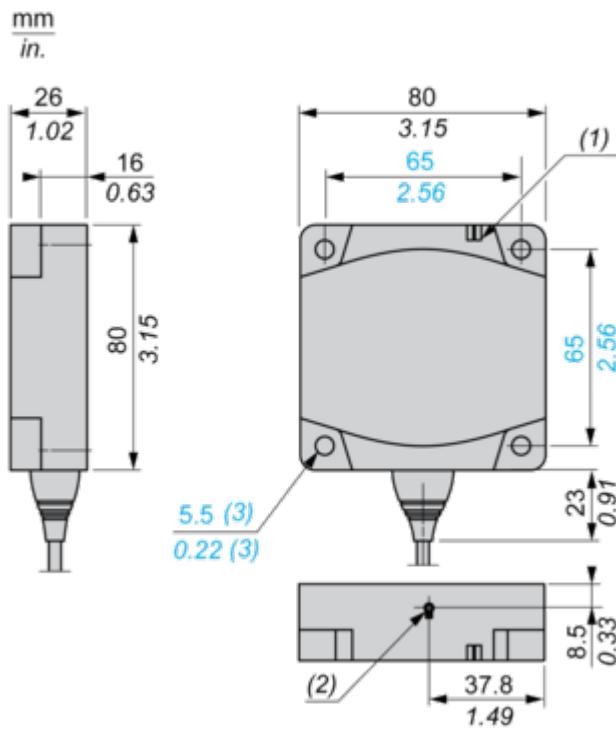

- (1) LED
- (2) Teach mode button
- (3) For CHC type screws

Mounting and Clearance

Setting-up

Minimum Mounting Distances (mm)

Side by Side

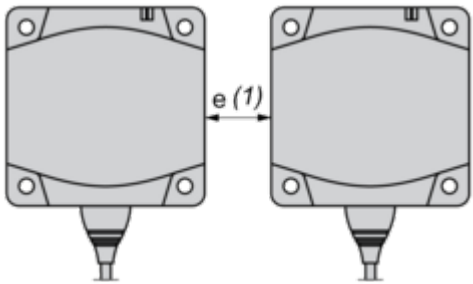

Face to Face

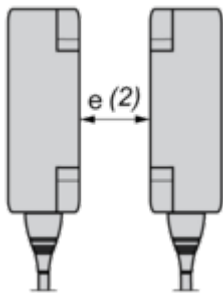

Facing a Metal Object

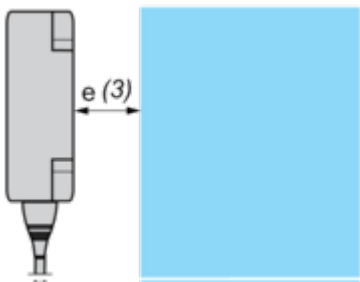

	e (1)	e (2)	e (3)
Flush mounted	200	400	40
Not flush mounted	600	not recommended	

Connections and Schema

Wiring Schemes

2-Wire NO Output

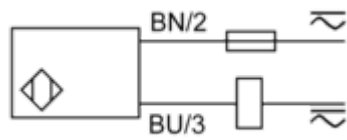

BU : Blue
BN : Brown