

Product data sheet

Specifications

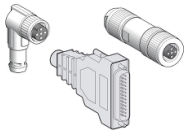

Industrial connector plate for EthernetIP, EtherCAT, Powerlink

VW3L1E001N01

Main

Product Or Component Type	Industrial connector plate for EthernetIP, EtherCAT, Ethernet Powerlink
Accessory / Separate Part Type	Connector
Accessory / Separate Part Category	Connection accessories
Accessory / Separate Part Destination	For Lexium integrated drive

Complementary

Range Compatibility	Lexium ILE Lexium ILA Lexium ILS
Communication Interface	Ethernet Powerlink EtherCAT Ethernet/IP
Kit Composition	2 connectors M12
Net Weight	0.22 kg

Packing Units

Unit Type Of Package 1	PCE
Number Of Units In Package 1	1
Package 1 Height	6.5 cm
Package 1 Width	13.0 cm
Package 1 Length	18.5 cm
Package 1 Weight	220.0 g
Unit Type Of Package 2	S03
Number Of Units In Package 2	8
Package 2 Height	30.0 cm
Package 2 Width	30.0 cm
Package 2 Length	40.0 cm
Package 2 Weight	2.473 kg

Contractual warranty

Warranty	18 months
----------	-----------

Disclaimer: This documentation is not intended as a substitute for and is not to be used for determining suitability or reliability of these products for specific user applications

Sustainability

Green Premium™ label is Schneider Electric’s commitment to delivering products with best-in-class environmental performance. Green Premium promises compliance with the latest regulations, transparency on environmental impacts, as well as circular and low-CO₂ products.

Guide to assessing product sustainability is a white paper that clarifies global eco-label standards and how to interpret environmental declarations.

[Learn more about Green Premium >](#)

[Guide to assess a product’s sustainability >](#)

Well-being performance

✓	Reach Free Of Svhc	
✓	Toxic Heavy Metal Free	
✓	Mercury Free	
✓	Rohs Exemption Information	Yes
✓	Pvc Free	
Reach Regulation	REACH Declaration	
Eu Rohs Directive	Pro-active compliance (Product out of EU RoHS legal scope) EU RoHS Declaration	
China Rohs Regulation	China RoHS declaration	
California Proposition 65	WARNING: This product can expose you to chemicals including: Lead and lead compounds, which is known to the State of California to cause cancer and birth defects or other reproductive harm. For more information go to www.P65Warnings.ca.gov	