

# Product data sheet

Specifications



## motion control stepper motor drive - SD215 - pulse/direction = 5A

SD215DU50C

### Main

Range Of Product	Lexium SD2
Product Or Component Type	Motion stepper drive
Device Short Name	SD215
Communication Interface	Pulse/direction

### Complementary

Network Number Of Phases	Single phase
[Us] Rated Supply Voltage	24...48 V
Supply Voltage Type	DC
Supply Voltage Limits	12...48 V
Maximum Motor Phase Current	5 A
Current Consumption	<= 4 mA
Input Current	10 µA - high level for SPI interfaces -10 µA - low level for SPI interfaces
Output Current	14.6 mA for step clock 8 mA - high level for SPI interfaces -7 mA - low level for SPI interfaces
Output Voltage	2.1 V high level (SPI interfaces) 0.5 V low level (SPI interfaces) 5...24 V high level (isolated inputs: step clock, direction, enable) 8.7 V low level (isolated inputs: step clock, direction, enable)
Input Voltage	2 V - high level for SPI interfaces signal inputs 1.2 V - low level for SPI interfaces signal inputs
Residual Ripple	2 V at nominal voltage
Electrical Connection	1 connector wire crimp 4 pins for motor interface 1 connector wire crimp 12 pins for multifunction and communication interface 1 connector wire crimp 2 pins for supply voltage 1 connector
Type Of Cooling	Convection
Width	76 mm
Height	54 mm
Depth	99 mm
Marking	CE
Net Weight	0.34 kg

### Environment

Disclaimer: This documentation is not intended as a substitute for and is not to be used for determining suitability or reliability of these products for specific user applications

Electromagnetic Compatibility	Electrostatic discharge conforming to IEC 61000-4-2 Immunity to radiated radio-electrical interference conforming to IEC 61000-4-3 Immunity to electrical transients conforming to IEC 61000-4-4 Voltage/current impulse conforming to IEC 61000-4-5 Immunity to voltage dips conforming to IEC 61000-4-11 Immunity to conducted RF disturbances conforming to IEC 61000-4-6
Standards	EN 55011 group 1 class A EN 61000-3-3 IEC 61000-3-2
Ambient Air Temperature For Operation	0...50 °C without derating with flange motor mounted on a steel plate 300 x 300 x 10 mm 50...65 °C with power derating of 2.2 % per °C with flange motor mounted on a steel plate 300 x 300 x 10 mm
Ambient Air Temperature For Storage	-25...70 °C
Relative Humidity	15...85 % without condensation
Operating Altitude	<= 1000 m without derating
Ip Degree Of Protection	IP20

## Packing Units

Unit Type Of Package 1	PCE
Number Of Units In Package 1	1
Package 1 Height	9 cm
Package 1 Width	13.4 cm
Package 1 Length	19.7 cm
Package 1 Weight	478 g

## Contractual warranty

Warranty	18 months
----------	-----------

## Sustainability

**Green Premium™ label** is Schneider Electric's commitment to delivering products with best-in-class environmental performance. Green Premium promises compliance with the latest regulations, transparency on environmental impacts, as well as circular and low-CO<sub>2</sub> products.

**Guide to assessing product sustainability** is a white paper that clarifies global eco-label standards and how to interpret environmental declarations.

[Learn more about Green Premium >](#)

[Guide to assess a product's sustainability >](#)

## Well-being performance

✓ Mercury Free	
✓ Rohs Exemption Information	Yes
✓ Pvc Free	
Reach Regulation	<a href="#">REACH Declaration</a>
Eu Rohs Directive	Pro-active compliance (Product out of EU RoHS legal scope)
China Rohs Regulation	<a href="#">China RoHS declaration</a>
California Proposition 65	WARNING: This product can expose you to chemicals including: Lead and lead compounds, which is known to the State of California to cause cancer and birth defects or other reproductive harm. For more information go to <a href="http://www.P65Warnings.ca.gov">www.P65Warnings.ca.gov</a>

Dimensions Drawings

Dimensions

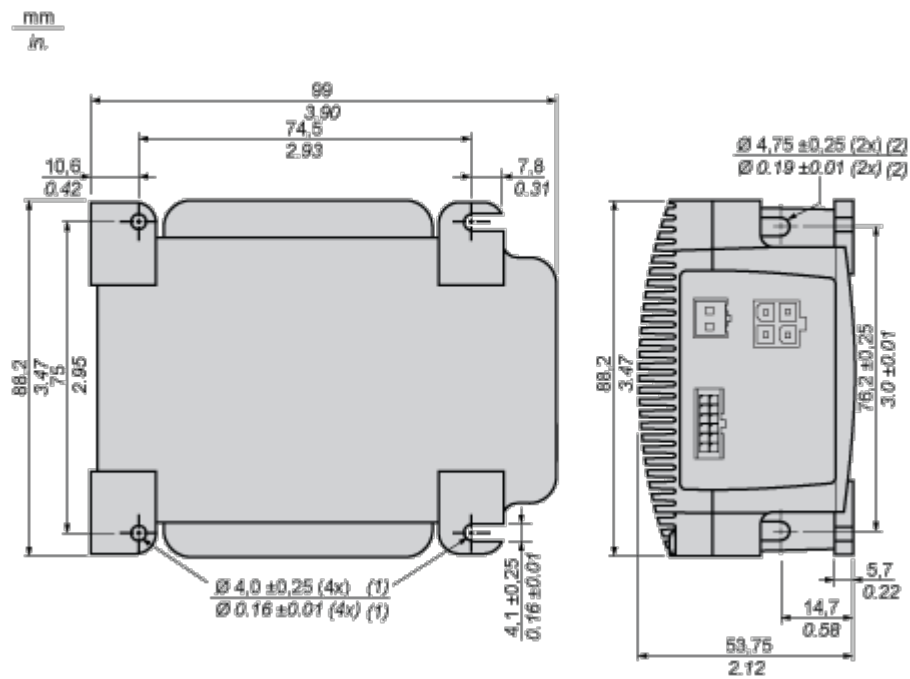

- (1) M3.5 screws for flat mount.
- (2) M4 screws for end mount.