

# Product data sheet

Specifications

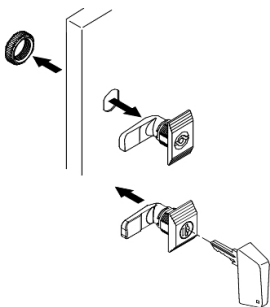

## Complete manual handle lock operated with key 220 (2) for Spacial CRN enclosure

NSYCL220CRN

### Main

Range	Spacial
Accessory / Separate Part Category	Locking accessory
Product Or Component Type	Lock
Application	Multi-purpose
Mounting Support	Direct mounting on standard lock
Product Compatibility	CRN enclosure
Range Compatibility	Spacial Spacial CRN
Device Composition	2 key 1 key lock 1 plastic cam

### Complementary

Quantity Per Set	Set of 1
Material	Lock: zamak + steel Cam: PA (polyamide)
Lock Type	Key lock
Type Of Keylock	Cylindrical
Key Number	220

### Packing Units

Unit Type Of Package 1	PCE
Number Of Units In Package 1	1
Package 1 Height	3.500 cm
Package 1 Width	4.500 cm
Package 1 Length	9.000 cm
Package 1 Weight	62.000 g
Unit Type Of Package 2	S02
Number Of Units In Package 2	40
Package 2 Height	15 cm
Package 2 Width	30 cm
Package 2 Length	40 cm
Package 2 Weight	2.721 kg
Unit Type Of Package 3	P12

Disclaimer: This documentation is not intended as a substitute for and is not to be used for determining suitability or reliability of these products for specific user applications

Number Of Units In Package 3	640
Package 3 Height	45.000 cm
Package 3 Width	80.000 cm
Package 3 Length	120.000 cm
Package 3 Weight	55.536 kg

## Contractual warranty

Warranty	18 months
----------	-----------

## Sustainability

**Green Premium™ label** is Schneider Electric's commitment to delivering products with best-in-class environmental performance. Green Premium promises compliance with the latest regulations, transparency on environmental impacts, as well as circular and low-CO<sub>2</sub> products.

**Guide to assessing product sustainability** is a white paper that clarifies global eco-label standards and how to interpret environmental declarations.

[Learn more about Green Premium >](#)

[Guide to assess a product's sustainability >](#)



Transparency   RoHS/REACH

## Well-being performance

✓ Mercury Free

✓ Rohs Exemption Information   [Yes](#)

## Certifications & Standards

Reach Regulation	<a href="#">REACH Declaration</a>
Eu Rohs Directive	Pro-active compliance (Product out of EU RoHS legal scope)
China Rohs Regulation	<a href="#">China RoHS declaration</a> Product out of China RoHS scope. Substance declaration for your information
Environmental Disclosure	<a href="#">Product Environmental Profile</a>
Circularity Profile	No need of specific recycling operations