

Product data sheet

Specifications

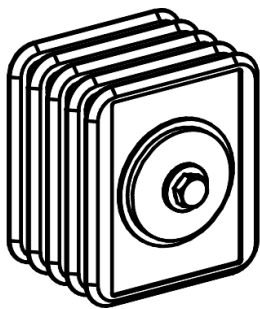

CANALIS KR 4X0800AL JUNCTION BLOCK / YA

KRA0800YA4

Main

Range	Canalis
Product Name	KR
Product Or Component Type	Electrical and mechanical jointing
Device Short Name	KRA
Range Compatibility	Canalis KR
Accessory / Separate Part Category	Connection accessory
Device Application	Jointing
Material	Aluminium
[Ie] Rated Operational Current	800 A with aluminium
Polarity	3L + N or 3L + PE or 3L + PEN

Complementary

Housing Material	Mineral epoxy resin
Contacts Material	Tinned aluminium
[Ue] Rated Operational Voltage	1000 V
Earth Conductor	Standard earth
Mounting Location	Indoor Outdoor
Mounting Support	Self-tapping screw
Product Certifications	EAC ATEX CE
Standards	IEC 61439-6
Fixing Mode	By 1 bolt
Tightening Torque	54 N.m
Width	90 mm
Height	90 mm
Colour	Grey (RAL 7030)
Quantity Per Set	Set of 1

Environment

Ip Degree Of Protection	IP68 conforming to IEC 60529
Ik Degree Of Protection	IK10 conforming to IEC 62262

Disclaimer: This documentation is not intended as a substitute for and is not to be used for determining suitability or reliability of these products for specific user applications

Pollution Degree	3
------------------	---

Packing Units

Unit Type Of Package 1	PCE
Number Of Units In Package 1	1
Package 1 Height	9.0 cm
Package 1 Width	9.0 cm
Package 1 Length	30.0 cm
Package 1 Weight	6.93 kg

Sustainability

Green Premium™ label is Schneider Electric's commitment to delivering products with best-in-class environmental performance. Green Premium promises compliance with the latest regulations, transparency on environmental impacts, as well as circular and low-CO₂ products.

Guide to assessing product sustainability is a white paper that clarifies global eco-label standards and how to interpret environmental declarations.

[Learn more about Green Premium >](#)

[Guide to assess a product's sustainability >](#)



Transparency RoHS/REACH

Well-being performance

✓ Reach Free Of Svhc

✓ Toxic Heavy Metal Free

✓ Mercury Free

✓ Rohs Exemption Information [Yes](#)

✓ Halogen Free Product

Certifications & Standards

Reach Regulation	REACH Declaration
Eu Rohs Directive	Compliant EU RoHS Declaration
China Rohs Regulation	China RoHS declaration Pro-active China RoHS declaration (out of China RoHS legal scope)
Environmental Disclosure	Product Environmental Profile
Weee	The product must be disposed on European Union markets following specific waste collection and never end up in rubbish bins
Circularity Profile	End of Life Information