

# Product data sheet

Specifications



## circuit breaker EasyPact EZC100N - TMD - 45 A - 1 pole 1d

EZC100N1045

⚠ Discontinued on: Oct 19, 2020

⚠ Discontinued

### Main

|  |   |
|--|---|
| Range Of Product                       | EasyPact  |
| Product Or Component Type              | Circuit breaker   |
| Device Short Name                      | Easypact EZC100N  |
| Circuit Breaker Name                   | Easypact EZC100N  |
| Device Application                     | Distribution  |
| Poles Description                      | 1P  |
| Protected Poles Description            | 1t  |
| Network Type                           | DC<br>AC  |
| Network Frequency                      | 50/60 Hz  |
| [In] Rated Current                     | 45 A at 40 °C   |
| [Ui] Rated Insulation Voltage          | 690 V AC 50/60 Hz conforming to IEC 60947-2   |
| [Uimp] Rated Impulse Withstand Voltage | 6 kV conforming to IEC 60947-2  |
| [Ue] Rated Operational Voltage         | 125 V DC conforming to IEC 60947-2<br>415 V AC 50/60 Hz conforming to IEC 60947-2   |
| Breaking Capacity Code                 | N   |
| Breaking Capacity                      | 25 kA Icu at 110...130 V AC 50/60 Hz conforming to IEC 60947-2<br>5 kA Icu at 125 V DC 1P conforming to IEC 60947-2<br>18 kA Icu at 220...240 V AC 50/60 Hz conforming to IEC 60947-2<br>2.5 kA Icu at 380...400 V AC 50/60 Hz conforming to IEC 60947-2<br>2.5 kA Icu at 415 V AC 50/60 Hz conforming to IEC 60947-2 |
| [Ics] Rated Service Breaking Capacity  | 2.5 kA at 125 V DC conforming to IEC 60947-2<br>9 kA at 220...240 V AC 50/60 Hz conforming to IEC 60947-2<br>1.25 kA at 380...400 V AC 50/60 Hz conforming to IEC 60947-2<br>1.25 kA at 415 V AC 50/60 Hz conforming to IEC 60947-2<br>12.5 kA at 110...130 V AC 50/60 Hz conforming to IEC 60947-2                   |
| Suitability For Isolation              | Yes conforming to IEC 60947-2   |
| Utilisation Category                   | Category A  |
| Trip Unit Name                         | TM-D  |
| Trip Unit Technology                   | Thermal-magnetic  |
| Trip Unit Rating                       | 45 A at 50 °C   |
| Protection Type                        | Overload protection<br>Short-circuit protection   |
| Pollution Degree                       | 3 conforming to IEC 60947   |

Disclaimer: This documentation is not intended as a substitute for and is not to be used for determining suitability or reliability of these products for specific user applications

## Complementary

|                            |   |
|----------------------------|---|
| Control Type               | Toggle  |
| Mounting Mode              | Fixed   |
| Mounting Support           | Backplate   |
| Upside Connection          | Front   |
| Downside Connection        | Front   |
| Mechanical Durability      | 8500 cycles   |
| Electrical Durability      | Category A: 1500 cycles 415 V AC 50/60 Hz conforming to IEC 60947-2 |
| Connection Pitch           | 25 mm   |
| Local Signalling           | Positive contact indication   |
| Neutral Protection Setting | Without protection  |
| Earth-Leakage Protection   | Without   |
| Height                     | 130 mm  |
| Width                      | 25 mm   |
| Depth                      | 60 mm   |

## Environment

|                                       |   |
|---------------------------------------|---|
| Standards                             | GB/T 14048.2<br>EN/IEC 60947-1<br>EN/IEC 60947-2<br>JIS C8201-2-2 |
| Ip Degree Of Protection               | IP20 conforming to IEC 60529                                      |
| Ik Degree Of Protection               | IK07 conforming to EN 50102                                       |
| Ambient Air Temperature For Operation | -25...70 °C   |
| Ambient Air Temperature For Storage   | -35...85 °C   |

## Contractual warranty

|          |           |
|----------|-----------|
| Warranty | 18 months |
|----------|-----------|

## Sustainability

**Green Premium™ label** is Schneider Electric's commitment to delivering products with best-in-class environmental performance. Green Premium promises compliance with the latest regulations, transparency on environmental impacts, as well as circular and low-CO<sub>2</sub> products.

**Guide to assessing product sustainability** is a white paper that clarifies global eco-label standards and how to interpret environmental declarations.

[Learn more about Green Premium >](#)

[Guide to assess a product's sustainability >](#)



Transparency   RoHS/REACH

## Well-being performance

✓ Reach Free Of Svhc

✓ Toxic Heavy Metal Free

✓ Mercury Free

✓ Rohs Exemption Information   [Yes](#)

## Certifications & Standards

Eu Rohs Directive   Compliant  
[EU RoHS Declaration](#)

China Rohs Regulation   [China RoHS declaration](#)

Environmental Disclosure   [Product Environmental Profile](#)

Weee   The product must be disposed on European Union markets following specific waste collection and never end up in rubbish bins

Dimensions Drawings

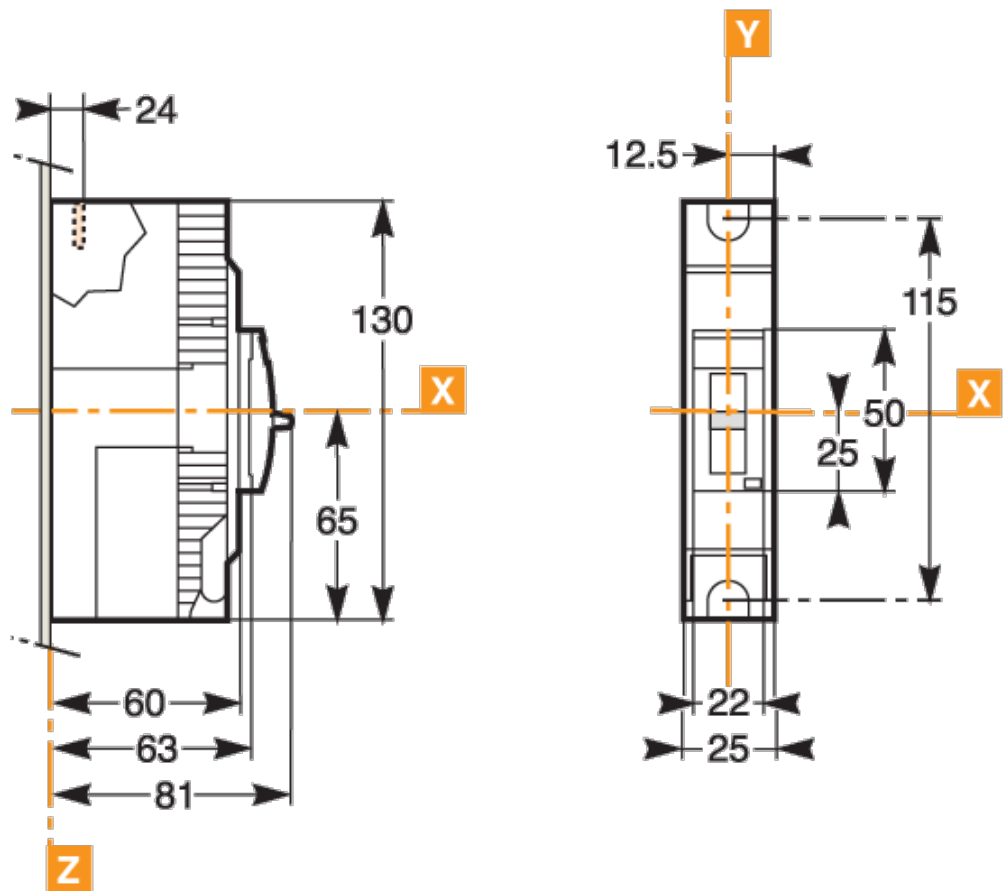

Assembly

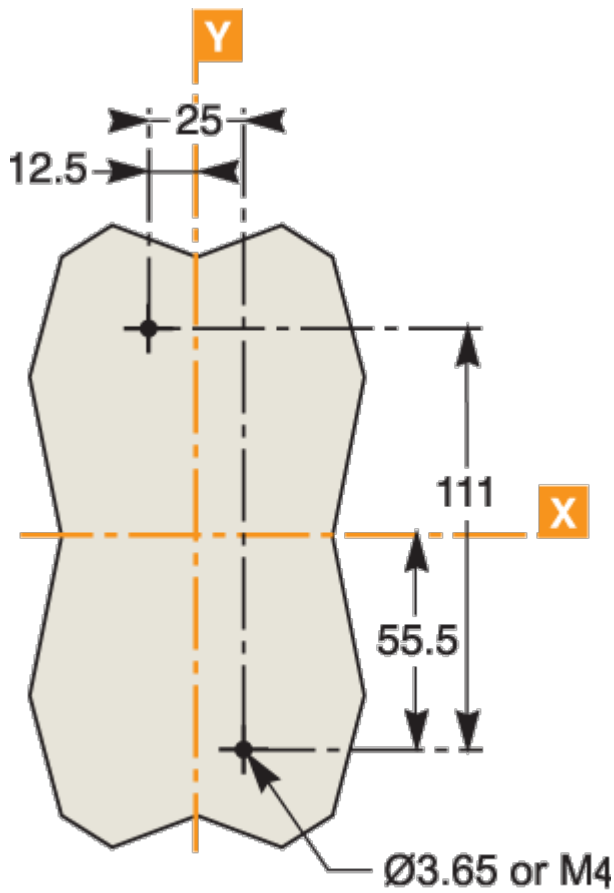

Performance Curves

