

Product data sheet

Specifications

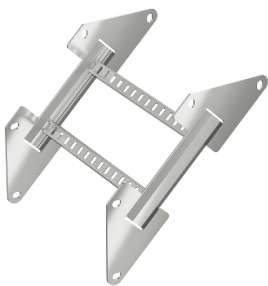

Wibe - riser coupling 20C-400 - steel hot-dip galvanized

CSU795161

 **Discontinued on:** Jan 3, 2022

 **Discontinued**

Important message: This product belongs to Cable Support which is no longer commercialized by Schneider Electric. As per the first of January 2022 the commercialization is managed by Wibe-Group, Please follow the link www.wibe-group.com for further details.

Main

Range	Wibe
Product Or Component Type	Riser coupling
Range Compatibility	Wibe

Complementary

Material With Surface Treatment	Steel, hot-dip galvanized
Corrosion Class	C3/C4
Height	170 mm
Width	400 mm
Depth	550 mm
Net Weight	300 kg / set of 100

Environment

Mounting Location	Area with high level of environmental corrosion, humidity and airborne pollution industrial and coastal areas, chemical plants
Standards	NEMA 20C

Packing Units

Unit Type Of Package 1	PCE
Number Of Units In Package 1	1
Package 1 Height	17 cm
Package 1 Width	40 cm
Package 1 Length	55 cm
Package 1 Weight	2.708 kg

Disclaimer: This documentation is not intended as a substitute for and is not to be used for determining suitability or reliability of these products for specific user applications