

# Product data sheet

Specifications



servo motor BCH, Lexium 28,  
180mm, 3000W, 54.1kg.cm<sup>2</sup>, with oil  
seal, with key, brake, straight  
connection

BCH2MR3013CF6C

## Main

Range Compatibility	Lexium 28
Product Or Component Type	Servo motor
Device Short Name	BCH2

## Complementary

Maximum Mechanical Speed	3000 rpm
[Us] Rated Supply Voltage	220 V
Network Number Of Phases	Three phase
Continuous Stall Current	16.49 A
Continuous Stall Torque	19.1 N.m for LXM26D at 19.8 A, 220 V, three phase 19.1 N.m for LXM28... at 19.8 A, 220 V, three phase
Continuous Power	3000 W
Peak Stall Torque	57.29 N.m for LXM26D at 19.8 A, 220 V, three phase 57.29 N.m for LXM28... at 19.8 A, 220 V, three phase
Nominal Output Power	3000 W for LXM26D at 19.8 A, 220 V, three phase 3000 W for LXM28... at 19.8 A, 220 V, three phase
Nominal Torque	19.1 N.m for LXM26D at 19.8 A, 220 V, three phase 19.1 N.m for LXM28... at 19.8 A, 220 V, three phase
Nominal Speed	1500 rpm for LXM26D at 19.8 A, 220 V, three phase 1500 rpm for LXM28... at 19.8 A, 220 V, three phase
Maximum Current Irms	58.4 A for LXM26D at 3 kW, 220 V 58.4 A for LXM28... at 3 kW, 220 V
Maximum Permanent Current	18.8 A
Product Compatibility	LXM26D servo drive motor at 3 kW, 220 V, three phase LXM28... servo drive motor at 3 kW, 220 V, three phase
Shaft End	Keyed
Shaft Diameter	35 mm
Shaft Length	79 mm
Key Width	10 mm
Feedback Type	20 bits single turn absolute encoder
Holding Brake	With
Holding Torque	48 N.m built-in
Mounting Support	Asian standard flange
Motor Flange Size	180 mm
Electrical Connection	Connector MIL

Disclaimer: This documentation is not intended as a substitute for and is not to be used for determining suitability or reliability of these products for specific user applications

Torque Constant	1.16 N.m/A at 20 °C
Back Emf Constant	70 V/krpm at 20 °C
Rotor Inertia	54.1 kg.cm²
Stator Resistance	0.234 Ohm at 20 °C
Stator Inductance	4.9 mH at 20 °C
Stator Electrical Time Constant	20.94 ms at 20 °C
Maximum Radial Force Fr	1200 N at 1500 rpm
Maximum Axial Force Fa	497 N
Brake Pull-In Power	49.6 W
Type Of Cooling	Natural convection
Length	235 mm
Number Of Motor Stacks	2
Centring Collar Diameter	114.3 mm
Centring Collar Depth	4 mm
Number Of Mounting Holes	4
Mounting Holes Diameter	13.5 mm
Circle Diameter Of The Mounting Holes	200 mm
Distance Shaft Shoulder-Flange	4 mm
Net Weight	23 kg

## Environment

Ip Degree Of Protection	IP50 IM V3 IP65 IM B5, IM V1
Ambient Air Temperature For Operation	0...40 °C

## Packing Units

Unit Type Of Package 1	PCE
Number Of Units In Package 1	1
Package 1 Height	24.5 cm
Package 1 Width	29 cm
Package 1 Length	58.5 cm
Package 1 Weight	24630 g
Unit Type Of Package 2	P06
Number Of Units In Package 2	4
Package 2 Height	50 cm
Package 2 Width	80 cm
Package 2 Length	60 cm
Package 2 Weight	107.42 kg

## Sustainability

**Green Premium™ label** is Schneider Electric's commitment to delivering products with best-in-class environmental performance. Green Premium promises compliance with the latest regulations, transparency on environmental impacts, as well as circular and low-CO<sub>2</sub> products.

**Guide to assessing product sustainability** is a white paper that clarifies global eco-label standards and how to interpret environmental declarations.

[Learn more about Green Premium >](#)

[Guide to assess a product's sustainability >](#)



Transparency   RoHS/REACH

## Well-being performance

✓ Reach Free Of Svhc

✓ Mercury Free

✓ Rohs Exemption Information   [Yes](#)

✓ Pvc Free

## Certifications & Standards

Reach Regulation	<a href="#">REACH Declaration</a>
Eu Rohs Directive	Pro-active compliance (Product out of EU RoHS legal scope)
China Rohs Regulation	<a href="#">China RoHS declaration</a>
Environmental Disclosure	<a href="#">Product Environmental Profile</a>
Weee	The product must be disposed on European Union markets following specific waste collection and never end up in rubbish bins
Circularity Profile	<a href="#">End of Life Information</a>
California Proposition 65	WARNING: This product can expose you to chemicals including: Lead and lead compounds, which is known to the State of California to cause cancer and birth defects or other reproductive harm. For more information go to <a href="http://www.P65Warnings.ca.gov">www.P65Warnings.ca.gov</a>

Dimensions Drawings

Dimensions

Dimensions of Motor

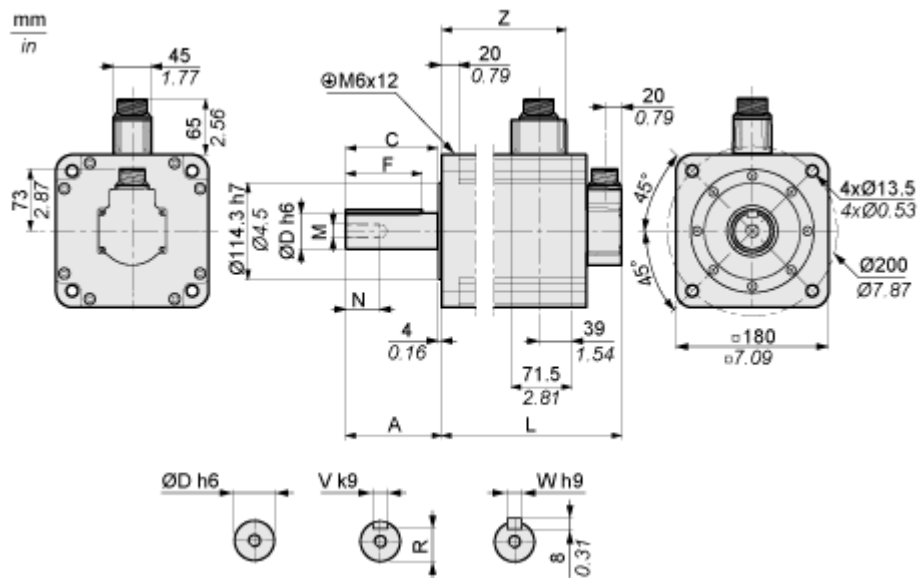

	mm	in.
L (without holding brake)	202	7.95
L (with holding brake)	235	9.25
A	79	3.11
C	73	2.87
D	35	1.38
F	63	2.48
N	28	1.10
M	M12	
R	30	1.18
V	10	0.39
W	10	0.39
Z	136	5.35

Performance Curves

Torque/Speed Curves with 230 V Three Phase Supply Voltage

Servo Motor with LXM28AU30 Servo Drive

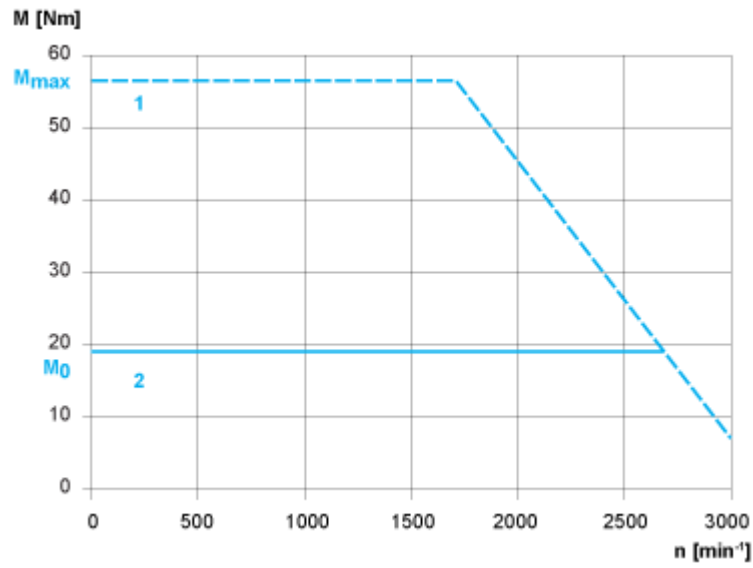

- 1 : Peak torque
- 2 : Continuous torque