

Product data sheet

Specifications



servo motor BCH, Lexium 28,
180mm, 2000W, without oil seal,
with key, straight connection

BCH2MR2021CA6C

 **Discontinued on:** Jun 30, 2023

 **Discontinued**

Main

| | |
|---------------------------|-------------|
| Range Compatibility | Lexium 28 |
| Product Or Component Type | Servo motor |
| Device Short Name | BCH2 |

Complementary

| | |
|---------------------------|---|
| Maximum Mechanical Speed | 3000 rpm |
| [Us] Rated Supply Voltage | 220 V |
| Network Number Of Phases | Three phase |
| Continuous Stall Current | 8.75 A |
| Continuous Stall Torque | 9.55 N.m for LXM28... at 12 A, 220 V, three phase 9.55 N.m |
| Continuous Power | 2000 W |
| Peak Stall Torque | 28.65 N.m for LXM28... at 12 A, 220 V, three phase 28.65 N.m |
| Nominal Output Power | 2000 W for LXM28... at 12 A, 220 V, three phase 2000 W |
| Nominal Torque | 9.55 N.m for LXM28... at 12 A, 220 V, three phase 9.55 N.m |
| Nominal Speed | 2000 rpm 2000 rpm for LXM28... at 12 A, 220 V, three phase |
| Maximum Current Irms | 35.4 A at 2 kW, 220 V |
| Maximum Permanent Current | 9.6 A |
| Product Compatibility | LXM28... servo drive motor at 2 kW, 220 V, three phase |
| Shaft End | Keyed |
| Shaft Diameter | 35 mm |
| Shaft Length | 79 mm |
| Key Width | 10 mm |
| Feedback Type | 20 bits single turn absolute encoder |
| Holding Brake | Without |
| Mounting Support | Asian standard flange |
| Motor Flange Size | 180 mm |
| Electrical Connection | Connector MIL |
| Torque Constant | 1.09 N.m/A at 20 °C |

Disclaimer: This documentation is not intended as a substitute for and is not to be used for determining suitability or reliability of these products for specific user applications

| | |
|---------------------------------------|--------------------|
| Back Emf Constant | 66 V/krpm at 20 °C |
| Rotor Inertia | 26.5 kg.cm² |
| Stator Resistance | 0.572 Ohm at 20 °C |
| Stator Inductance | 8.86 mH at 20 °C |
| Stator Electrical Time Constant | 15.49 ms at 20 °C |
| Maximum Radial Force Fr | 1200 N at 2000 rpm |
| Maximum Axial Force Fa | 497 N |
| Brake Pull-In Power | 49.6 W |
| Type Of Cooling | Natural convection |
| Length | 169 mm |
| Number Of Motor Stacks | 1 |
| Centring Collar Diameter | 114.3 mm |
| Centring Collar Depth | 4 mm |
| Number Of Mounting Holes | 4 |
| Mounting Holes Diameter | 13.5 mm |
| Circle Diameter Of The Mounting Holes | 200 mm |
| Distance Shaft Shoulder-Flange | 4 mm |
| Net Weight | 13 kg |

Environment

| | |
|---------------------------------------|---------------------------------|
| Ip Degree Of Protection | IP54 IM B5, IM V1 IP50 IM V3 |
| Ambient Air Temperature For Operation | -20...40 °C |

Packing Units

| | |
|------------------------------|----------|
| Unit Type Of Package 1 | PCE |
| Number Of Units In Package 1 | 1 |
| Package 1 Height | 24.5 cm |
| Package 1 Width | 29.0 cm |
| Package 1 Length | 58.5 cm |
| Package 1 Weight | 15.18 kg |

Sustainability

Green Premium™ label is Schneider Electric's commitment to delivering products with best-in-class environmental performance. Green Premium promises compliance with the latest regulations, transparency on environmental impacts, as well as circular and low-CO₂ products.

Guide to assessing product sustainability is a white paper that clarifies global eco-label standards and how to interpret environmental declarations.

[Learn more about Green Premium >](#)

[Guide to assess a product's sustainability >](#)



Transparency RoHS/REACH

Well-being performance

✓ Reach Free Of Svhc

✓ Mercury Free

✓ Rohs Exemption Information [Yes](#)

Certifications & Standards

| | |
|---------------------------|---|
| Reach Regulation | REACH Declaration |
| Eu Rohs Directive | Pro-active compliance (Product out of EU RoHS legal scope) |
| China Rohs Regulation | China RoHS declaration |
| Environmental Disclosure | Product Environmental Profile |
| Weee | The product must be disposed on European Union markets following specific waste collection and never end up in rubbish bins |
| Circularity Profile | End of Life Information |
| California Proposition 65 | WARNING: This product can expose you to chemicals including: Lead and lead compounds, which is known to the State of California to cause cancer and birth defects or other reproductive harm. For more information go to www.P65Warnings.ca.gov |

Dimensions Drawings

Dimensions

Dimensions of Motor

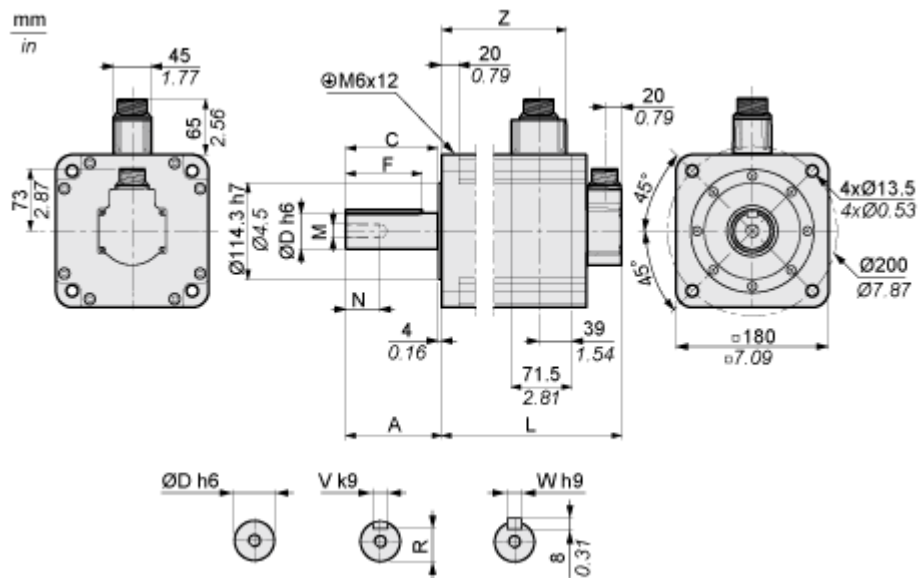

| | mm | in. |
|---------------------------|-----|------|
| L (without holding brake) | 169 | 6.65 |
| L (with holding brake) | 203 | 7.99 |
| A | 79 | 3.11 |
| C | 73 | 2.87 |
| D | 35 | 1.38 |
| F | 63 | 2.48 |
| N | 28 | 1.10 |
| M | M12 | |
| R | 30 | 1.18 |
| V | 10 | 0.39 |
| W | 10 | 0.39 |
| Z | 103 | 4.06 |

Performance Curves

Torque/Speed Curves with 230 V Three Phase Supply Voltage

Servo Motor with LXM28AU20 Servo Drive

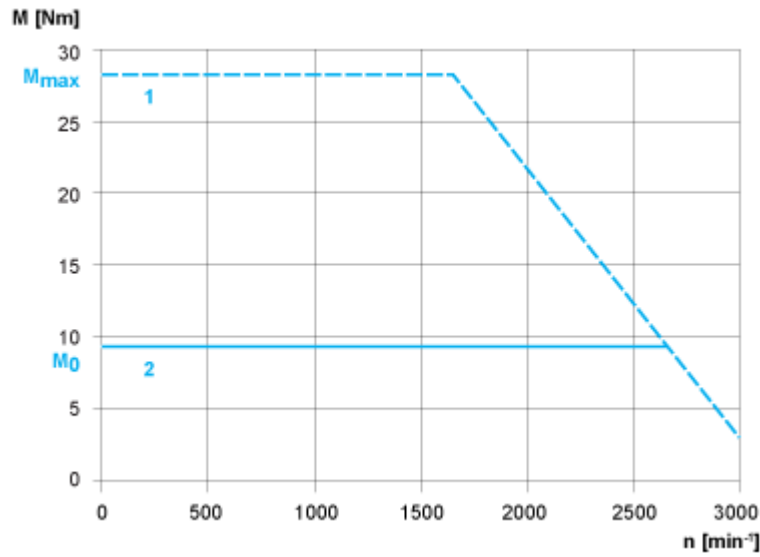

- 1 : Peak torque
- 2 : Continuous torque