

Product data sheet

Specifications

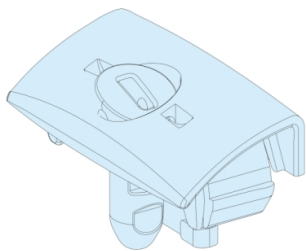

1/4 T LOCKING FRONT PLATE(2by10)

01094

 **Discontinued on:** Apr 25, 2023

 **Discontinued**

Main

Range	Prisma
Range Of Product	Prisma P Prisma G
Product Or Component Type	Quarter-turn closing
Accessory / Separate Part Category	Spare part
Range Compatibility	Prisma Prisma G enclosure Prisma Prisma P cubicle

Complementary

Installation Description	Cubicle Wall-mounted enclosure Floor-standing enclosure
Quantity Per Set	Set of 1
Height	24 mm
Width	46 mm
Depth	10 mm
Net Weight	0.58 kg

Packing Units

Unit Type Of Package 1	PCE
Number Of Units In Package 1	1
Package 1 Height	5.5 cm
Package 1 Width	14.8 cm
Package 1 Length	27.5 cm
Package 1 Weight	520 g
Unit Type Of Package 2	S04
Number Of Units In Package 2	16
Package 2 Height	30 cm
Package 2 Width	40 cm
Package 2 Length	60 cm
Package 2 Weight	9.35 kg
Unit Type Of Package 3	P12

Disclaimer: This documentation is not intended as a substitute for and is not to be used for determining suitability or reliability of these products for specific user applications

Number Of Units In Package 3	128
Package 3 Height	78 cm
Package 3 Width	80 cm
Package 3 Length	120 cm
Package 3 Weight	98 kg

Sustainability

Green Premium™ label is Schneider Electric's commitment to delivering products with best-in-class environmental performance. Green Premium promises compliance with the latest regulations, transparency on environmental impacts, as well as circular and low-CO₂ products.

Guide to assessing product sustainability is a white paper that clarifies global eco-label standards and how to interpret environmental declarations.

[Learn more about Green Premium >](#)

[Guide to assess a product's sustainability >](#)



Transparency RoHS/REACH

Well-being performance

✓ Reach Free Of Svhc

✓ Toxic Heavy Metal Free

✓ Mercury Free

✓ Rohs Exemption Information [Yes](#)

✓ Halogen Free Plastic Parts Product

Certifications & Standards

Eu Rohs Directive	Pro-active compliance (Product out of EU RoHS legal scope) EU RoHS Declaration
-------------------	---

China Rohs Regulation	China RoHS declaration Pro-active China RoHS declaration (out of China RoHS legal scope)
-----------------------	---

Environmental Disclosure	Product Environmental Profile
--------------------------	---

Circularity Profile	End of Life Information
---------------------	---